

Facilities & Construction Report

PROJECT STATUS 9/18/2017

Current Projects

- **New Construction**
 - Roofing Status
 - Laughlin Campus
- **Facility Painting**
 - Garfield
 - Chavira
- **Facility Repairs**
 - San Felipe Memorial Middle School
- **Technology – Public Broadcast Channel 39**

New Construction

Roofing Project - Ruben Chavira Elementary School



- District Buildings 100% Completed
- Completion of District Wide Project – 9/15/2017 - Revised Date – 10/01/2017

New Construction

Laughlin Base School



- Approve Grading Site Plan – In Progress
- Furniture Meeting – TBD
- Complete Final Floor Plans – 10/1/2017
- Final Plan Review – 10/1/2017
- Advertise for RFCP – 10/1/2017
- Receive RFCP – 10/24/2017
- Award Contracts – 11/1/2017

Laughlin Base School – Site Plan

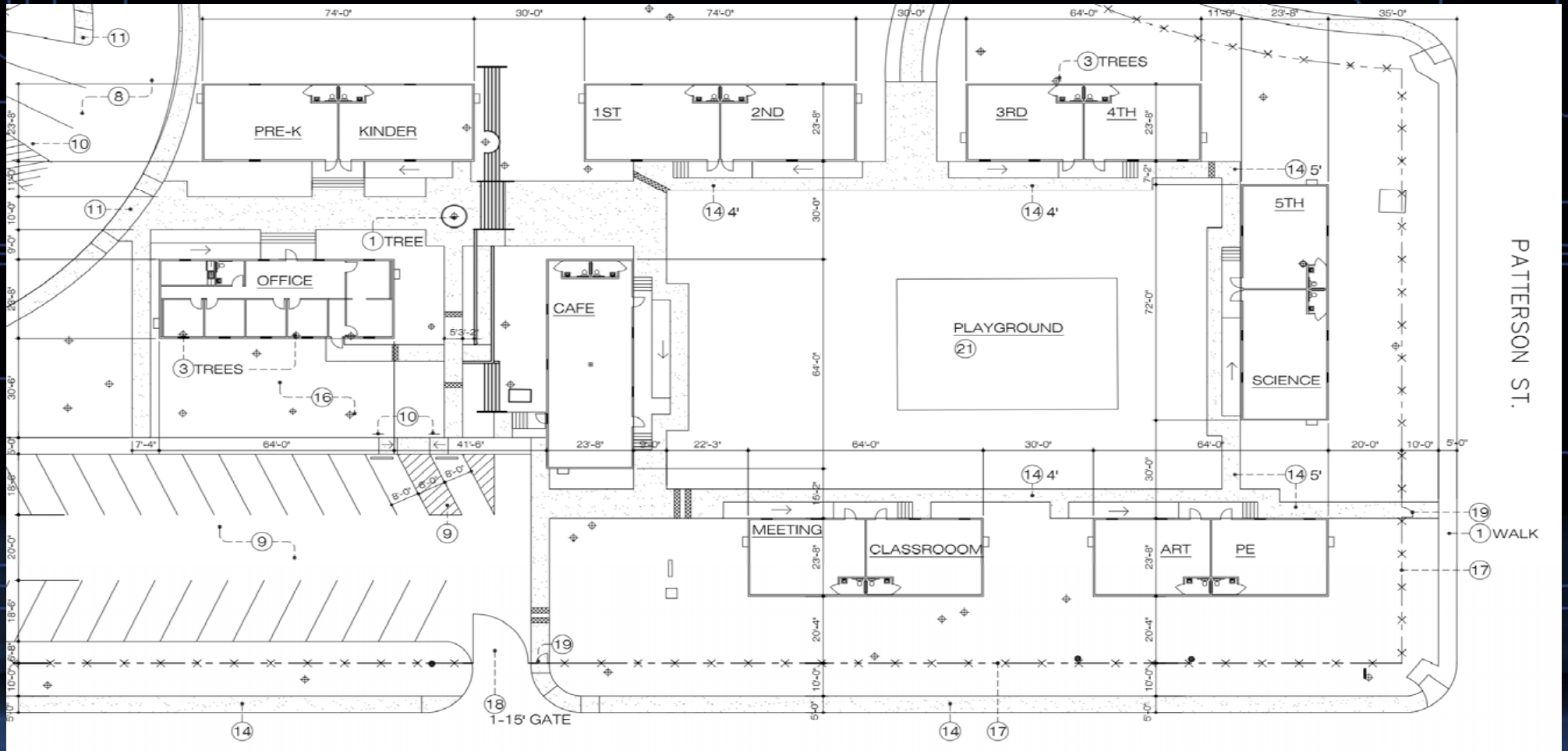

Facility Painting Project

Garfield Elementary
Completed



Ruben Chavira Elementary
In Progress



Facility Repairs

San Felipe Memorial Middle School - Gym



Technology

Public Broadcast – Channel 39 (Relocation & Upgrade)



- ▣ ~~Construction Phase Completed – 7/26/2017~~
- ▣ Spectrum Encoder Upgrade (Rescheduled) 9/21/2017
- ▣ SFDR Encoder Upgrade (Rescheduled) 9/22/2017
- ▣ Channel 39 Completion – Tentative 9/29/2017

The background is a dark blue gradient with a complex geometric pattern of thin, light blue lines and circles. The lines form a grid-like structure with various rectangular and circular shapes, some overlapping. The circles are of different sizes and are scattered across the frame, some partially cut off by the edges. The overall effect is a technical or architectural aesthetic.

Questions?